

LT-CPS Series

120~347VAC LED 4", 6", 8", 10" IC & Non-IC
 Selectable Wattage and CCT, Commercial
 J-Box Down Light



Catalog #		Type
Project		Date
Prepared by		



Specification

Model No.	LT-CPS-D20W-35W			LT-CPS-D40W-35T		
Type	IC			NON IC		
Wattage Adjustable Option	10W	15W	20W	27W	34W	40W
Lumens	800	1200	1,600	2,160	2,720	3,200
Efficacy	80 LM/W			80 LM/W		
CCT Adjustable	3000K, 3500K, 4000K			3000K, 3500K, 4000K		
1-10V Dimming	✓			✓		
120-347VAC Input	✓			✓		
cUL-us	✓			✓		
Energy Star	4", 6", 8"			4", 6", 8", 10"		

Note: * All efficacy is ±5% base on different CCT and trim size. Check the IES file to gain the accurate data.

Engine

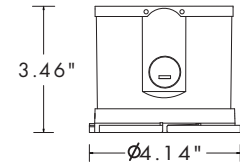

20W IC

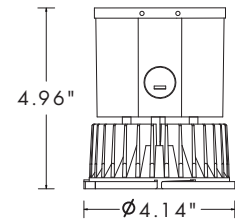

40W NON IC

Product Performance

Structure

Spun aluminum reflector integrated with haze finish and white trim ring with shadow free.

Trim Options

- Round Trim: 4", 6", 8", 10"
- Square Trim: 4", 6"
- Round Wall Wash Trim: 4", 6"
- Square Wall Wash Trim: 4", 6"

Electrical

LED Driver	It is powered by Class 2 high efficiency 120-347V LED driver, with a standard 1-10V driver which continuous dims to 10% that works with many types of controls. Tested Dimmers: Lutron © Diva-Dvtv, Leviton © IP-710-DL.
THD	<20%
Power Factor	>0.9
Input Voltage	Standard electronic drivers are cUL-us recognized.

LED System

CRI	Minimum 80 color rendering index
Wattage	3-selectable wattages
CCT	3-CCT Adjustable settings
Thermal Management	Aluminum housing acting as the heat sink to maximize life.

Mounting

Durable tension clips are allowing for fast and easy flush installation

Approvals

- cUL-us listed for damp locations
- Energy Star Listed
- Tested to IESNA LM-79 and LM-80

Warranty

5-year limited warranty on LED and driver.

Optional Function

Emergency Option	Optional high power 100-277V emergency LED driver for lighting up to 120 minutes in event of power failure.
------------------	---

Ordering Information

LED Module	Trim Shape	-Aperture	Mounting Kit & Emergency Driver
LT-CPS-D20W-35W = Wattage & CCT Adjustable (10W/15W/20W) (3000K/3500K/4000K)	RT = Round Trim for 4", 6", 8", 10" ST = Square Trim for 4" and 6"	-4 = 4" -6 = 6" -8 = 8" -10 = 10"	NCFK4R = 4" Round Mounting Frame NCFK4S = 4" Square Mounting Frame NCFK6R = 6" Round Mounting Frame NCFK6S = 6" Square Mounting Frame NCFK8R = 8" Round Mounting Frame NCFK10R = 10" Round Mounting Frame EM = Emergency Battery Backup Driver
LT-CPS-D40W-35T = Wattage & CCT Adjustable (27W/34W/40W) (3000K/3500K/4000K)	RWW = Round Wall Wash Trim for 4" and 6" SWW = Square Wall Wash Trim for 4" and 6"		

Example : **LT-CPS-D40W-35T / RT6 / NCFK6R**

Trim Dimensions

Round Trims

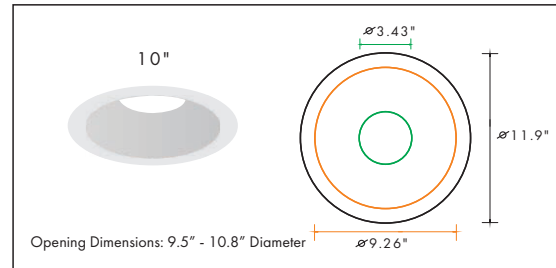
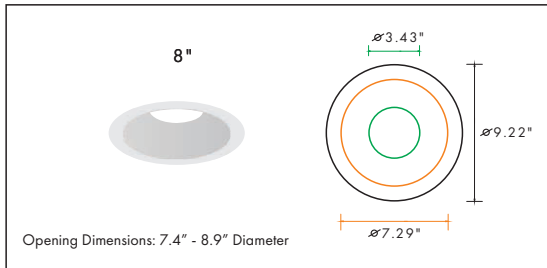
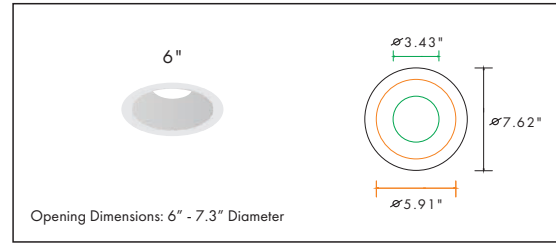
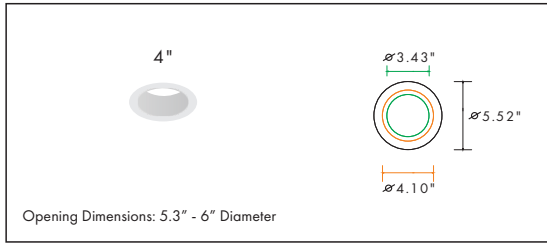

Round Wall Wash Trims

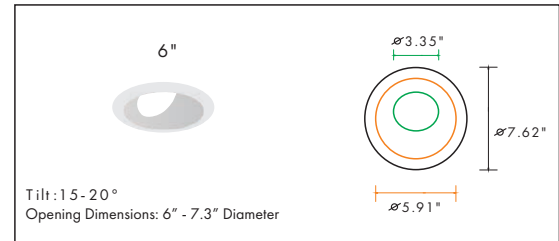
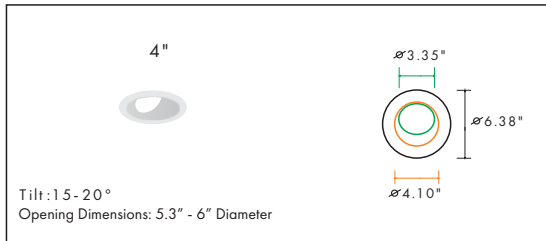

Square Trims

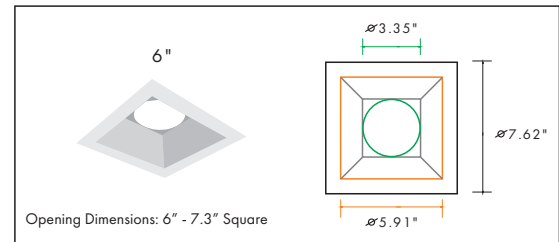
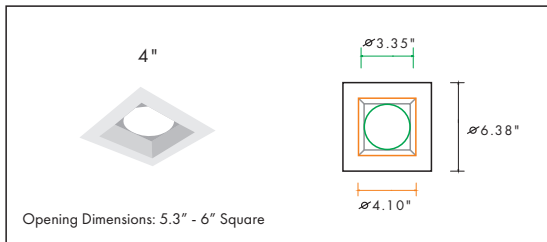

Square Wall Wash Trims

