

# LT-CPS Series

120~347VAC LED 4", 6", 8", 10" IC & Non-IC  
 Selectable Wattage and CCT, Commercial  
 J-Box Down Light



Catalog #		Type
Project		Date
Prepared by		



## Specification

Model No.	LT-CPS-D20W-35W			LT-CPS-D40W-35T		
Type	IC			NON IC		
Wattage Adjustable Option	10W	15W	20W	27W	34W	40W
Lumens	800	1200	1,600	2,160	2,720	3,200
Efficacy	80 LM/W			80 LM/W		
CCT Adjustable	3000K, 3500K, 4000K			3000K, 3500K, 4000K		
1-10V Dimming	✓			✓		
120-347VAC Input	✓			✓		
cUL-us	✓			✓		
Energy Star	4", 6", 8"			4", 6", 8", 10"		

Note: \* All efficacy is ±5% base on different CCT and trim size. Check the IES file to gain the accurate data.

## Engine

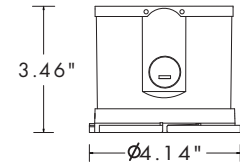

20W IC

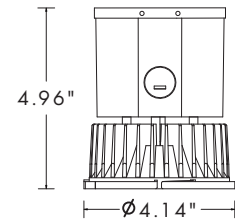

40W NON IC

## Product Performance

### Structure

Spun aluminum reflector integrated with haze finish and white trim ring with shadow free.

### Trim Options

- Round Trim: 4", 6", 8", 10"
- Square Trim: 4", 6"
- Round Wall Wash Trim: 4", 6"
- Square Wall Wash Trim: 4", 6"

### Electrical

LED Driver	It is powered by Class 2 high efficiency 120-347V LED driver, with a standard 1-10V driver which continuous dims to 10% that works with many types of controls. Tested Dimmers: Lutron® Diva-Dvtv, Leviton® IP-710-DL.
THD	<20%
Power Factor	>0.9
Input Voltage	Standard electronic drivers are cUL-us recognized.

### LED System

CRI	Minimum 80 color rendering index
Wattage	3-selectable wattages
CCT	3-CCT Adjustable settings
Thermal Management	Aluminum housing acting as the heat sink to maximize life.

### Mounting

Durable tension clips are allowing for fast and easy flush installation

### Approvals

- cUL-us listed for damp locations
- Energy Star Listed
- Tested to IESNA LM-79 and LM-80

### Warranty

5-year limited warranty on LED and driver.

### Optional Function

Emergency Option	Optional high power 100-277V emergency LED driver for lighting up to 120 minutes in event of power failure.
------------------	---

## Ordering Information

LED Module	Trim Shape	-Aperture	Mounting Kit & Emergency Driver
<b>LT-CPS-D20W-35W</b> = Wattage & CCT Adjustable (10W/15W/20W) (3000K/3500K/4000K)	<b>RT</b> = Round Trim for 4", 6", 8", 10" <b>ST</b> = Square Trim for 4" and 6"	<b>-4</b> = 4" <b>-6</b> = 6" <b>-8</b> = 8" <b>-10</b> = 10"	<b>CPS-R-FRAME</b> = 4", 6", 8" Round Mounting Frame <b>CPS-S-FRAME</b> = 4", 6" Square Mounting Frame <b>NCFK10R</b> = 10" Round Mounting Frame <b>LT-CPS-EM-H08170-LBF</b> = Emergency Driver
<b>LT-CPS-D40W-35T</b> = Wattage & CCT Adjustable (27W/34W/40W) (3000K/3500K/4000K)	<b>RWW</b> = Round Wall Wash Trim for 4" and 6" <b>SWW</b> = Square Wall Wash Trim for 4" and 6"		

Example : **LT-CPS-D40W-35T / RT6 / NCFK6R**

# Trim Dimensions

## Round Trims

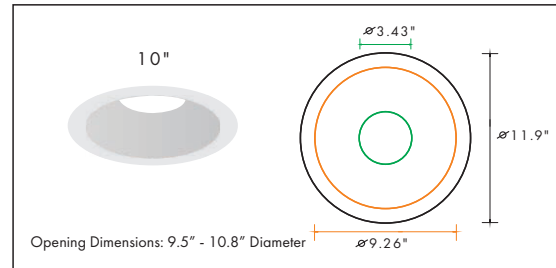
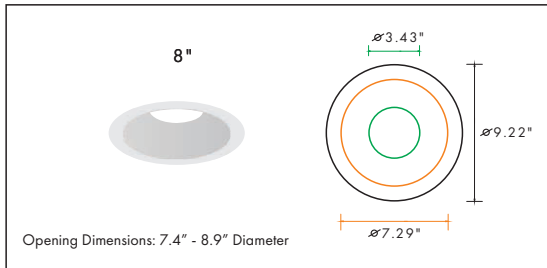
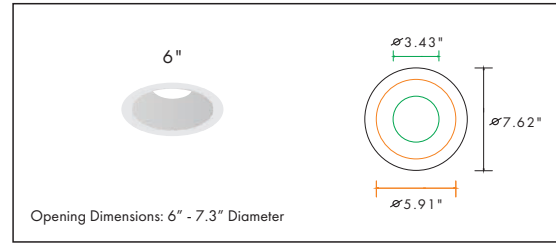
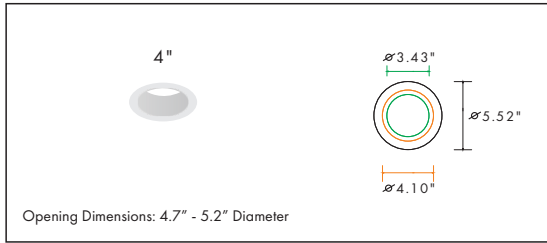

## Round Wall Wash Trims

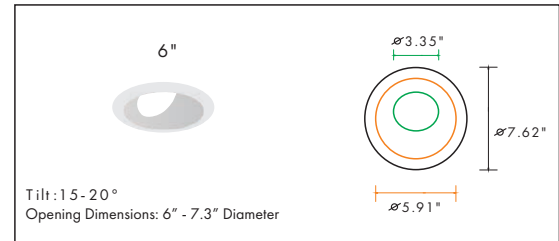
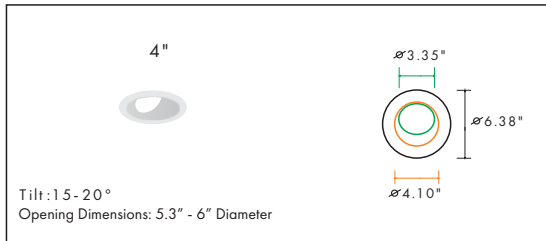

## Square Trims

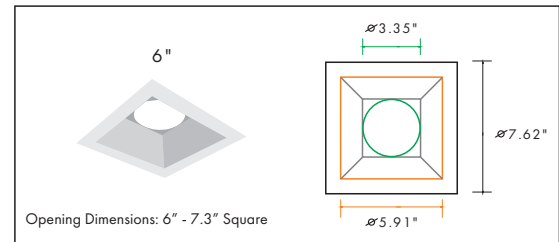
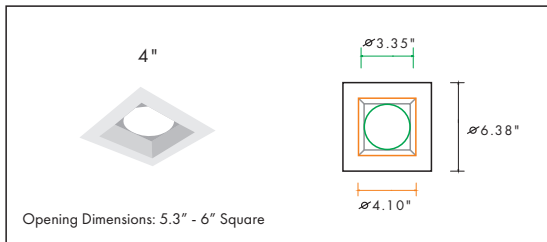

## Square Wall Wash Trims

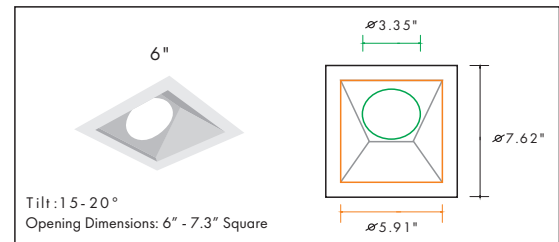
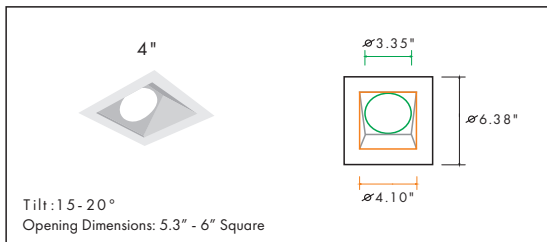

## CPS-R-FRAME Dimensions

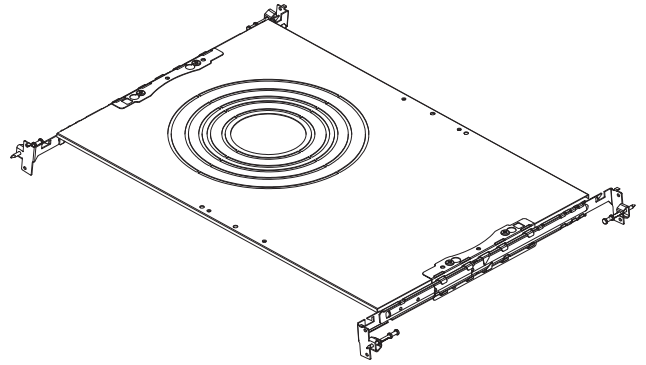
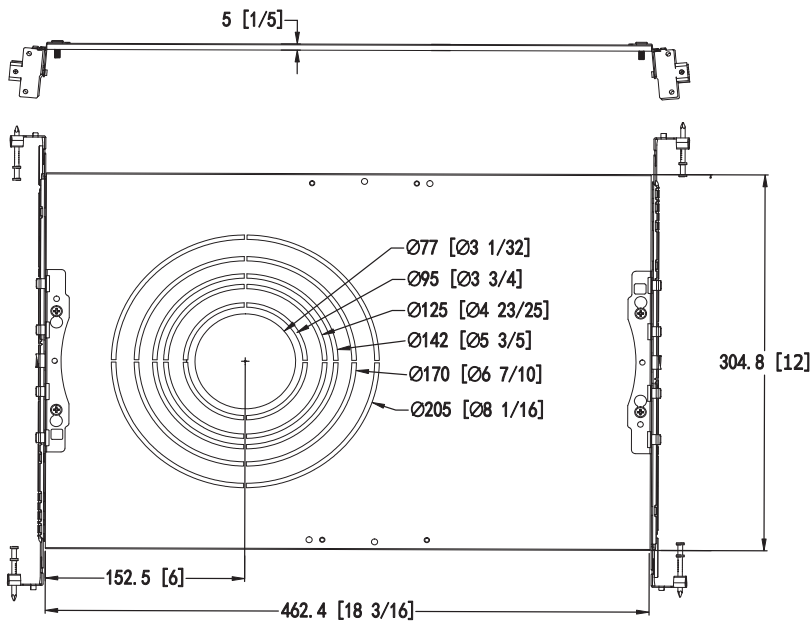

## CPS-S-FRAME Dimensions

