

LED-AF6AD

120VAC LED DoB 6" Recessed Gimbal Retrokit with E26 or Optional GU24 base Adapter

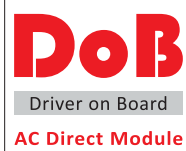

Catalog #		Type
Project		Date
Prepared by		

6" LED

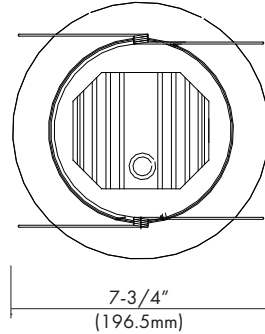

3-3/16"
(80.6mm)

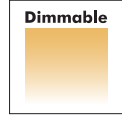
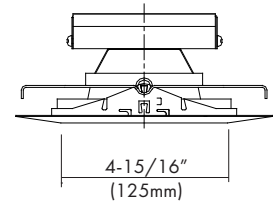

DESCRIPTION

The 6" LED DoB Gimbal Retrokit with E26 medium base Adapter ideal for 6" IC/Airtight and Non-IC incandescent recessed downlights and has an optional GU24 adapter for CFL housings. It is designed for use with Lum-Tech models IH-620ICA, IH-620, shallow IH-640ICA, IH-640 and most 6" housings certified under UL1598 standard. High efficacy 120VAC LED DoB (Driver on Board) Module (Campcell®) with integral triac dimmer capability. The optical diffusing lens produces high lumen transmission and even illumination. Suitable for Damp Location.

DESIGN FEATURES

LED Module

- Efficient aluminum extrusion heat sink with integrated LED DoB module.
- Gimbal head rotates 358 degrees and can tilt 0 - 30 degrees.
- High reflectance Reflector improves beam distribution and uniformity

Lens

- High impact translucent plastic lens.
- High lumen transmission and diffusing for even illumination.

Mounting

- Precision formed steel torsion springs easily adjust to 6" housings.
- Dual torsion springs easily mount into compatible 6" recessed housings that have spring mounting tabs.

Compatible Housings

- See Housing Compatibility section

Electrical Connection:

- E26 medium Edison connector provides easy retrofit of screw based incandescent housings.
- Optional GU24 base Adapter available for CFL housings.
- 120VAC LED Power Supply on-board with state-of-the-art customized IC chip (DoB).
- 10-100% triac dimming with most of leading and trailing edge incandescent & low voltage dimmer switches.
- Advanced driver circuit design (Pat. Pending) prevents damage to the LED module and switch from common inrush currents.
- Recommended for use max. 45 fixtures per run on a 600W max load dimmer switch. 23 fixtures per run on a 300W max load dimmer switch.

Limited Warranty

- LED Module: 5 years/50K hours
- Product: 3 years

Listing

- ENERGY STAR
- California Title 24

SPECIFICATION	
Input Voltage	120VAC
Wattage (+/-5%)	12.5 W
Lumen (+/-5%)	900lm
Efficacy (LPW)	72 lm/W
Beam Angle	74°
CRI (Typical)	80, 90
CCT (Color +/-5%)	2700K, 3000K, 3500K, 4000K
Dimming	Triac
LED Module	5 yr/50K hr
Environment	Damp Location

Trailing Edge Dimmer	
- Lutron® Model Numbers :	
• Diva® DVCL Series	• Diva® DVLV Series
• Nova T ⁺ NT Series	• Glyder® GLV Series
• Ariadni® AYCL Series	• RadioRA 2® 10ND Series
• Skylark® SLV Series	• Skylark® SLV Series
• Skylark® Contour CTCL Series	
• Maestro Wireless MRF2-6ND Series	
• Lutron® Homeworks® RPM-4U	
• Lutron® Homeworks® QS HQRD-6ND Series	
• Lutron® Homeworks® QS HQRD-10ND Series	
- Leviton® Model Numbers :	
• SureSlide 6633	
Leading Edge Dimmer	
- Lutron® Model Numbers :	
• Diva® DVELV Series	• Skylark® SELV Series
• Nova T ⁺ NTELV Series	• RadioRA RRD-6NA Series
• Maestro MAELV Series	• Maestro MRF2-6ELV Series
• Lutron® Grafik Eye PHPM-PA Series	
• Lutron® Homeworks® QS HQRD-6NA Series	
<i>Consult tech. service or factory for additional dimmers</i>	

HOUSING COMPATIBILITY

LED-AF6AD ETL Listed for installation in the following Lum-Tech E26 screw based 6" standard and shallow recessed housings;

- 6" : IH-620ICA, IH-620ICAR, IH-610, IH-620R, Shallow: IH-640ICA, IH-640ICAR, IH-640, IH-640R

LED-AF6AD ETL Listed for retrofit in the following 6" recessed housing;

- **Halo** : H7ICAT, H7RICAT, H7ICT, H7RICT, H7ICATNB, H7ICTNB, H7T, H7RT, H7TNB, H7TCP, H7UICAT, H7UICAT, H27ICAT, H27RICAT, H27ICT, H27RICT, H27T, H27RT, H5ICAT, H5RICAT, H5T, H5RT, H25ICAT
- **All-Pro** : EI700AT, EI700RAT, E700ATNB, EI700, EI700R, EI700ATNB, EI700NB, ET700, ET700R, EI700U, EI700UAT, E2700AT, EI2700, EI2700R, ET2700, ET2700R
- **Juno** : IC22, IC22R, IC22W, IC22S, IC23, IC23W, IC21, IC21R, TC2, TC2R, IC20, IC20R, IC25, IC25R, IC25W, IC25S, TC20, TC20R
- **Capri** : CR1, PR1, QL1, R9ASIC
- **Lithonia** : L7X, L7XP
- **Thomas** : PS1, R9ASIC/PS9RM
- **Prescolite** : IBXS

PHOTOMETRIC REPORT

* Contact Factory for IES File

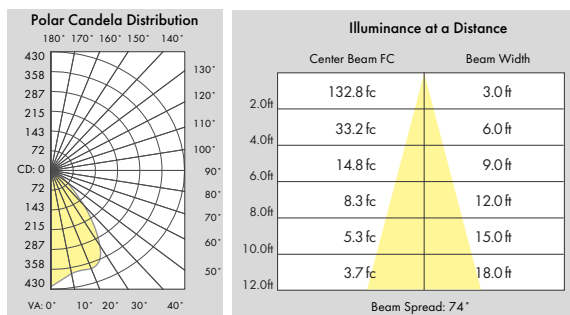

[LED-AF6AD-830DOB]

Ordering Information

Model	-CRI	Color Temp.*	Finish*	Driver	-Options
LED-AF6AD = 6", 120VAC, 12.5W Recessed Gimbal Retrofit	-8 = 80 CRI -9 = 90 CRI	27 = 2700K 30 = 3000K 35 = 3500K 40 = 4000K	blank = White (Standard)	DOB = 120V Direct Driver on Board (dimable with most Line or Low Voltage Dimmers)	-GU24A = GU24 Adapter -ZE = Genderless Quick Connector (Select when ordering with LEDH Housings)

Example : LED-AF6AD-830DOB-GU24A

* Consult factory for other Color Temperatures and Finishes