



# ICED9535, DLED9535

120-277VAC, 3.5" IC Airtight and Non-IC Type LED Round Architectural Downlight



Test Specification			
[ ICED9535-xx UZTD		TML324ST-xx-830W-WHWH ]	
LED Quantity	1 EA (COB)		
Input Voltage	120~277V		
Wattage (+/-5%)	<b>10W</b>	<b>14W</b>	<b>23W</b>
Lumen (+/-5%)	845	1,187.2	2,000
Efficacy (LPW) (+/-5%)	84.5	79.2	86.9
Luminaire Beam	49°	49°	43.5°
CCT (Color +/-5%)	2700K, 3000K, 3500K, 4000K		
CRI (Typical)	80, 90		
Dimming	0~10V, ELV & TRIAC Optional Lutron Drivers		
LED Module	5 yr or 50K hr		
Environment	Damp Location & optional Wet Location		

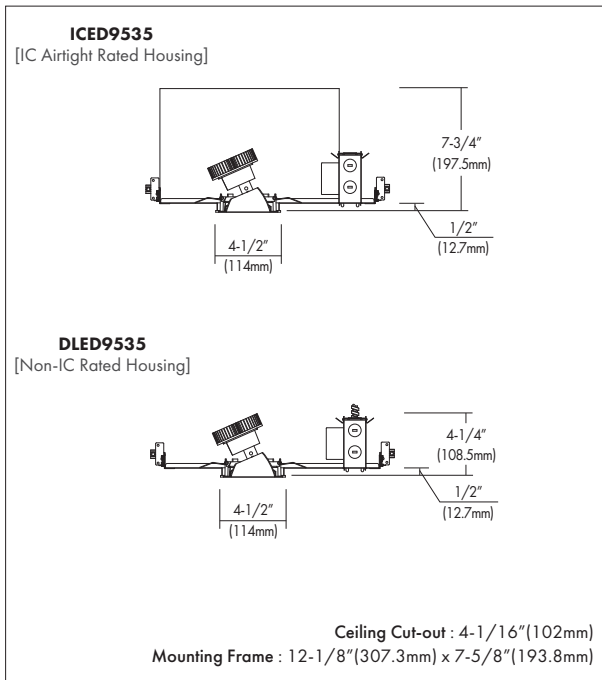

### Design Features

- Interchangeable reflectors to achieve different beam distributions.
- Minimum Trim reveals are 0.12" thick.
- Multiple reflector distribution patterns available: pinhole trim with Narrow Spot (NS), Narrow beam (N), Medium beam (M), and Wide beam (W).
- Designed for ceiling thickness up to 1-1/4".
- Adjustable trims allow engine to be angled 0°~30° tilt with a 356° rotation for precise, lockable aiming.
- Wall Wash trim with angled slope reflector. Molded spread lens for great uniformity.
- Dimming capability is standard with 0-10V dimmer switches.
- Optional Lutron Hi-lume 1%, LED drivers are available. Lutron drivers provide flicker-free, smooth, continuous dimming down to 1%. (Contact factory for dimming system requirements)
- The ICED9535 luminaire is listed as Type IC and is suitable for direct contact with insulation.
- Certified to IESNA LM-79: Approved Method for the Electrical and Photometric Testing of Solid State Lighting. The U.S. Department of Energy (DOE) verifies product test data and results. LED chip sets are in compliance with LM80.
- cETLus Listed.

Trims : Various finishes available for straight (ST), Adjustable (AJ), Adjustable Pinhole (PAJ) and wall wash (WW) down lights.



**TML324RST**

Straight down symmetrical reflector.

**TML325RAJ**

Accurate vertical & horizontal aiming through the aperture from below ceiling.

**TML334PAJ**

1-1/16" pinhole on surface of aperture adjustable to 30° with angle cut slope reflector.

**TML325RGWW**

30° angle cut wall wash reflector with linear spread lens.

### Option

**TML-324-MUD**

[ 4-1/2" Round Flangeless Mud Ring ]

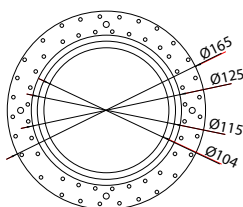

# ICED9535, DLED9535

120-277VAC, 3.5" IC Airtight and Non-IC Type LED Round Architectural Downlight

## PHOTOMETRIC REPORT\*

\* Contact Factory for IES File

Polar Candela Distribution

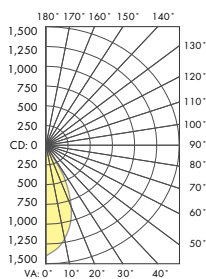

[TML324RST-10-830W]

Illuminance at a Distance

Center Beam FC	Beam Width
350.5 fc	1.8 ft
87.6 fc	3.7 ft
38.9 fc	5.5 ft
21.9 fc	7.3 ft
14.0 fc	9.2 ft
9.7 fc	11.0 ft

Beam Spread: 49°

## Ordering Information

### Housing

ICED9535 = IC Airtight

DLED9535 = Non-IC

### -Watts

-10 = 10W

-14 = 14W

-23 = 23W

### Driver\*

UZTD = 120~277VAC, 0~10V Dimming

UTMD = 120~277VAC, Tri-Mode(0~10V/Triac/ELV)  
Dimming

LDE1 = LUTRON, Hi-lume 1% EcoSystem FadeToBlack

PEQ01 = LUTRON, Hi-lume Premier 0.1% EcoSystem  
FadeToBlack (For 23W or less only)

\*Option : Emergency (Non-IC only)

-EM = Emergency Battery Backup

### Trim/LED Kit\*

TML324RST = Straight

TML325RAJ = Adjustable

TML334PAJ = Pinhole Adjustable

TML325RGWW = Wall Wash

### -Wattage

-10 = 10W

-14 = 14W

-23 = 23W

### -CRI

-8 = 80

-9 = 90

### Color Temp.\*\*

27 = 2700K

30 = 3000K

35 = 3500K

40 = 4000K

### Beam Angle

Upper Reflector:

NS = Narrow Spot 15°

N = Narrow 24°

M = Medium 38°

W = Wide 60°

### -Finishes\*\*

Reflector:

-HC = Haze Clear (Standard)

-WH = White

Trim:

-WH = White (Standard)

-BK = Black

\*Option : Sealed Lens

-WRL = Wet Location

-TML-324-MUD = Flangeless Mud Ring

\*\* Consult factory for other Color Temperatures and Finishes