

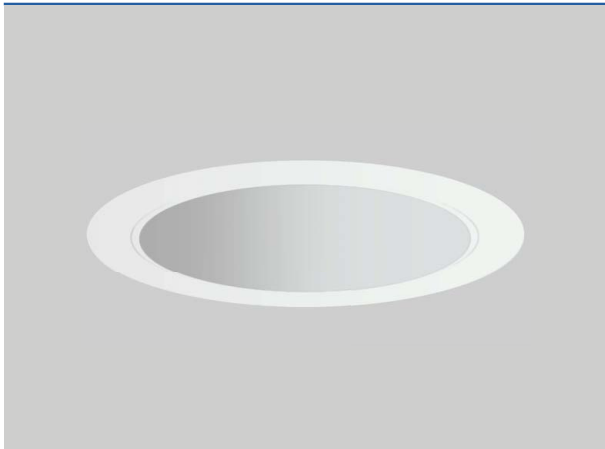

ICED-9521, DLED-9521 (Special Order Fixtures)

Universal 120-277VAC LED, 2" LED, IC Airtight and Non-IC type Round Architectural Recessed Lights



Test Specification			
	ICED-9521	TML-112R-ST-xx-830-UZTD-WH-WH-M	
LED Quantity	1 EA (COB)		
Input Voltage	120~277V		
Wattage (+/-5%)	10W	15W	23W*
Lumen (+/-5%)	870	1,200	1,800
Efficacy (LPW) (+/-5%)	87	80	78.3
CCT (Color +/-5%)	2700K, 3000K, 3500K, 4000K		
CRI (Typical)	80, 90		
Dimming	0-10V/TRIAC/ELV Dimming		
LED Module	5 yr or 50K hr		
Environment	Indoor, Damp		

*23W NON-IC Only

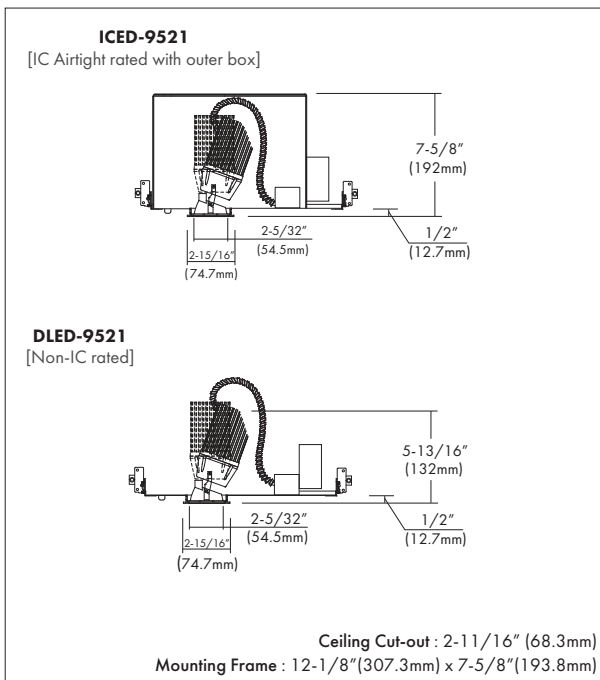

Design Features

- Four different beam distributions available: Narrow Spot, Narrow, Medium, and Wide
- Designed for ceiling thickness up to 1-1/4".
- All results are according to IESNA LM-79-2008 : Approved Method for the Electrical and Photometric Testing of Solid-State Lighting. The US. Department of Energy (DOE) verifies product test data and results. LED chips provided with fixtures are in compliance with LM80.
- Listing: CSA us

Trims : Various trims for straight down lights (-ST), Adjustable (-AJ)



TML-112R-ST

- Straight reflector cone.
- Included "Solite" soft focus lens.

TML-112R-AJ

30° Angle accurately aiming for vertical surface through aperture from below ceiling, and 350° rotatable.

Option

TML-124R-MUD

[2-15/16" Round Flangeless Mud Ring]

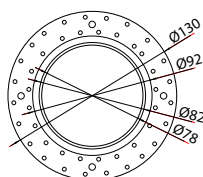

ICED-9521, DLED-9521 (Special Order Fixtures)

Universal 120-277VAC LED, 2" IC Airtight and Non-IC type
Round Architectural Recessed Lights

Ordering Information

Housing

ICED-9521 = 2" Round IC Airtight Housing

DLED-9521 = 2" Round Non-IC Housing

LED Trim / Module

TML-112R-ST = Straight

TML-112R-AJ = Adjustable

-Watts

-10 = 10W

-15 = 15W

-23 = 23W (NON-IC ONLY)

-CRI

-8 = 80

-9 = 90

Color Temp. **

27 = 2700K

30 = 3000K

35 = 3500K

40 = 4000K

-Beam Angle

Upper Reflector:

-NS = Narrow Spot 15°

-N = Narrow 24°

-M = Medium 38°

-W = Wide 60°

Driver*

UTD = 120~277VAC, Triac/ELV Dimming

UZTD = 120~277VAC, 0~10V Dimming

UTMD = 120~277VAC, Tri-Mode(0~10V/
Triac/ELV) Dimming

*Option : Emergency (Non-IC only)

-EM = Emergency Battery Backup

NOTE: Requires access above the ceiling or install an access panel to service emergency battery and LED driver.

-Finish

Reflector:

-WH = White (Standard)

-SI = Silver

-BRZ = Bronze

-BK = Black

Trim:

-WH = White (Standard)

-SI = Silver

-BRZ = Bronze

-BK = Black

*Option :

-WRL = Wet Location Sealed Lens

-TML-124R-MUD = Flangeless Mud Ring

** Consult factory for other Color Temperatures and Finishes