

# ICED466S, DLED466S

120-277VAC, 4" X 4" IC and Non-IC Type LED Square Architectural Downlight

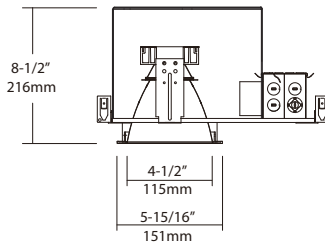

**ICED466S**  
[IC Rated Housing]



**DLED466S**  
[Non-IC Rated Housing]

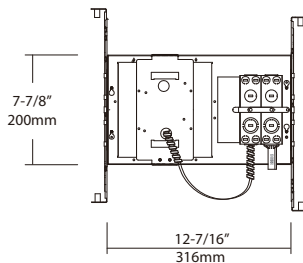
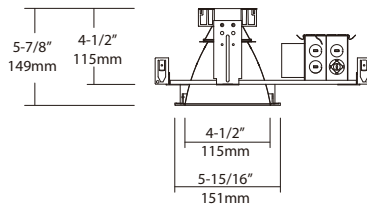

Ceiling Cut-out : 5-1/2" x 5-1/2" (140x140mm)

Test Specification			
LED Quantity	1 EA (COB)		
Input Voltage	120~277V		
Wattage (+/-5%)	<b>14W</b>	<b>23W</b>	<b>30W</b>
Lumen (+/-5%)	941	1,515	2,014
Efficacy (LPW) (+/-5%)	67.2	65.9	67.1
Luminaire Beam	54°	54°	54°
CCT (Color +/-5%)	2700K, 3000K, 3500K, 4000K		
CRI (Typical)	80, 90		
Dimming	Triac/ELV, Triac/ELV/0-10V, or Lutron Dimming		
LED Module	5 yr or 50K hr		
Environment	Damp Location & *optional Wet Location		

### Design Features

- 20 gauge 4.5" x 4.5" square aperture housing adjusts ceilings up to 1-1/4" thick.
- Semi-matte diffuse lower reflectors under the upper reflector.
- 60° cutoff to light source.
- Multiple Trim options available.
- Light engine and driver can be replaceable through aperture below ceiling.
- Universal, 120~277 VAC input, high efficiency dimming drivers with ① dimmer switches or ② Triac/ELV/0-10V dimmer switches.
- Provided listed j-box and adjustable height and multiple channel brackets.
- Optional Lutron Hi-lume 1%, LED drivers are available. Lutron drivers provide flicker-free, smooth, continuous dimming down to 1%. (Contact factory for dimming system requirements)
- c-ETL-us Listed.

### Trims



**QT-522**

Haze Clear Square Reflector with Regressed Frosted Lens

**QT-529**

Haze Clear Square Reflector

**QT-535R**

Haze Clear Square Reflector with Flat Frosted Lens

**QT-538**

Haze Clear Square Wall Wash Reflector with Linear Spread Lens

# ICED466S, DLED466S

120-277VAC, 4" X 4" IC and Non-IC Type LED Square Architectural Downlight

## Option

### TML-519-MUD

[ 5" Square Flangeless Mud Frame ]

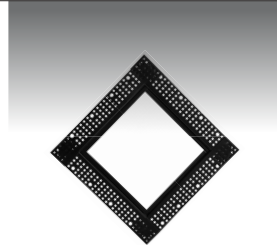
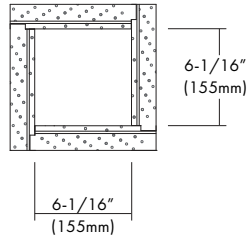

Trimless Ceiling Cut-out : 6-3/8" (162mm)SQ

## PHOTOMETRIC REPORT\*

\* Contact Factory for IES File

### Polar Candela Distribution

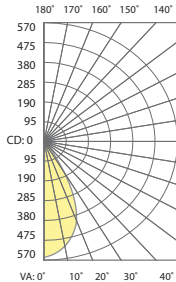

### Illuminance at a Distance

Center Beam FC	Beam Width
656.4 fc	2.0 ft
164.1 fc	4.0 ft
72.9 fc	6.0 ft
41.0 fc	8.0 ft
26.3 fc	10.0 ft
18.2 fc	12.0 ft

Beam Spread: 54°

### Triac/ELV/0-10V Approved Dimmers

#### \* Lutron:

Triac: Skylark S-600  
 ELV: NovaT NTELV-300 & 600  
 Diva DVELV-300P & 303P  
 Maestro MAELV-600  
 Skylark SEL-VB-300P

0-10V: Diva DDTV  
 Diva DVSTV-IV

CFL/LED: Diva DVCL-253P  
 Ariadni AYCL-253P

#### \* Leviton:

Triac: Trimatron #705W  
 ELV: IPE04-1L (ELV)  
 Acenti: ATE06-1LW

\* Consult tech. service or factory for additional dimmers

## Ordering Information

### Housing

ICED466S = IC Housing  
 DLED466S = Non-IC Housing

### -Watts

-14 = 14W  
 -23 = 23W  
 -30 = 30W (Non-IC Housing Only)

### -CRI

-8 = 80  
 -9 = 90

### Color Temp. \*\*

27 = 2700K  
 30 = 3000K  
 35 = 3500K  
 40 = 4000K

### Driver\*

UTD = 120~277VAC, Triac/ELV Dimming  
 UZTD = 120~277V, Triac/ELV/0-10V Dimming  
 LDE1 = LUTRON, Hi-lume 1% EcoSystem FadeToBlack  
 LTE = LUTRON, Hi-lume 1% 2-Wire Dimming  
 PEQ01 = LUTRON, Hi-lume Premier 0.1% EcoSystem  
 FadeToBlack (For 23W or less only)  
 UDALI = Universal DALI Dimming to 1%

\*Option : Emergency

-EM = Emergency Battery Backup with Remote Test Switch

### Trim/LED Kit\*

QT-522  
 QT-529  
 QT-535R  
 QT-538

### -Finishes\*\*

Reflector:  
 -HC = Haze Clear

Trim:  
 -WH = White

\*Option:  
**TML-519-MUD** = Flangeless Mud Frame

\*\* Consult factory for other Color Temperatures and Finishes