

WARNING

1. Risk of Fire - Supply conductors (power wires) connecting the fixture must be rated minimum 90°C. If uncertain consult an electrician.
2. Risk of Electric Shock - Disconnect power at fuse or circuit breaker before installing or servicing.
3. Risk of Fire/Electric Shock - If not qualified, consult an electrician.

CAUTIONS :

1. For your safety read and understand instructions completely before starting installation.
2. These luminaires (fixtures) are designed to meet the latest NEC requirements and are listed in full compliance with UL 1598.
3. Before attempting installation, check your local electrical code, as it sets the wiring standards for your locality.

NOTES:

1. If luminaire (fixture) is to be switched from a wall switch, make sure black power supply wire is connected to the switch. **DO NOT** connect the white supply wire to the switch.
2. Make certain no bare wires are exposed outside the wire nut connectors.

Housing Compatibility

LED-ARFK4 ETL Classified for retrofit in the following 4" housings;

LUM-TECH	4" Commercial/Architectural CFL,HID,INCAND Downlight
----------	--

LED-ARFK6 ETL Classified for retrofit in the following 6" housings;

LUM-TECH	6" Commercial/Architectural CFL,HID,INCAND Downlight
Halo	PD6V142E, PD6V120, PD6V501E, PD6V701E, PD6V1001E
Juno	CV6-118T, CV6-126Q, CV6-126/32T, TC906, MX6-XX, M6-XX
Lithonia	LP6F, CCR62, LP6H, LP6

LED-ARFK8 ETL Classified for retrofit in the following 8" housings;

LUM-TECH	8" Commercial/Architectural CFL,HID,INCAND Downlight
Halo	PD7V142E, PD7V120, PD7V501E, PD7V701E, PD7V1001E, PD7V70X1E, PD7V100X1E
Juno	CV8-126/32/42T, TC908, MX8-(70,100), M8-(70,100)
Lithonia	LP8F, CCR82, LP8H, LP8

Installation Into Recessed housing

1. Turn power off at fuse or circuit breaker box.
2. Remove existing lamp and trim/reflector.
3. Remove the j-box box cover from existing frame housing.
4. Disconnect wiring to existing insulation detector or wiring to existing socket housing/ballast to remove from electrical circuit.
5. Flexible conduit whip into j-box in ceiling. (Fig. 1)

Figure 1

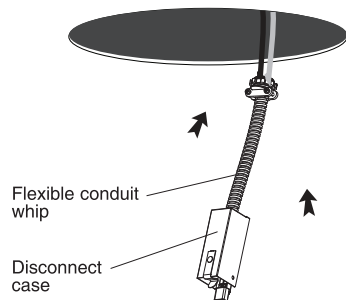

6. Remove appropriate round knockout and connect metallic cable included with the flexible conduit whip to j-box with proper connector(s). (Fig. 2)
7. Connect supply wires. Connect white to white; black to black. after connect the green to green. Be sure no bare current carrying wire is exposed. (Fig. 3)
8. Place wires and connections back in j-box and replace cover.
9. Plug the female connector of the retrofit-kit onto the male connector of the flexible conduit whip assembly. (Fig. 4)

Figure 2

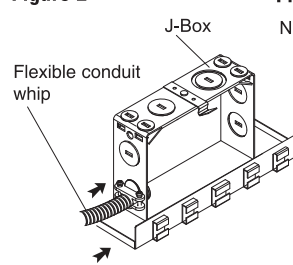
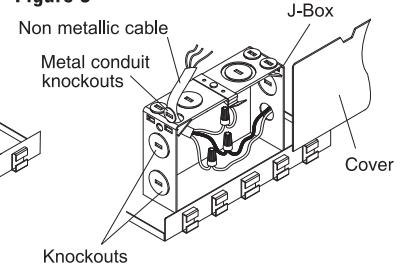

Figure 3



10. Connect disconnect case(Patent pending) by snap-on fit.
11. Tuck flexible conduit whip into to the housing and carefully push the retrofit-kit into existiiing housing. (Fig. 5)

Figure 4

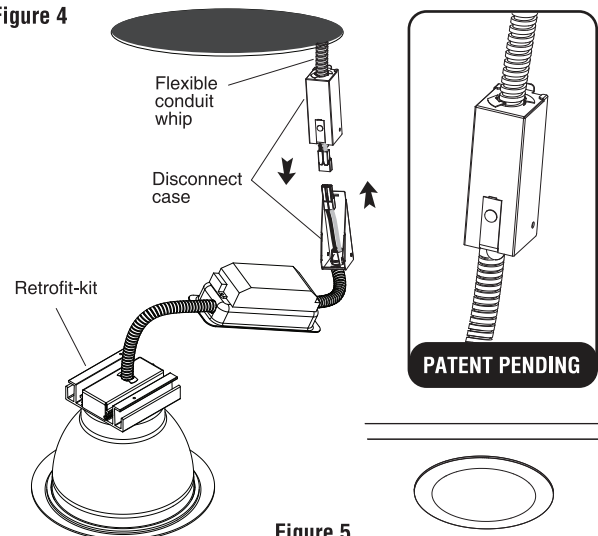

Figure 5

120V Approved Dimmers

- Lutron: NovaT (Ntelv300&600), Diva (Dvelv-300P&303P)
- Leviton: Acenti: Ate06-1Lw
- Leviton: Trimatron #705W (Incandescent)

Consult tech. service or factory for additional dimmers

Clip Installation (Options)

If use with larger aperture housings, place extra clips on housing as below.

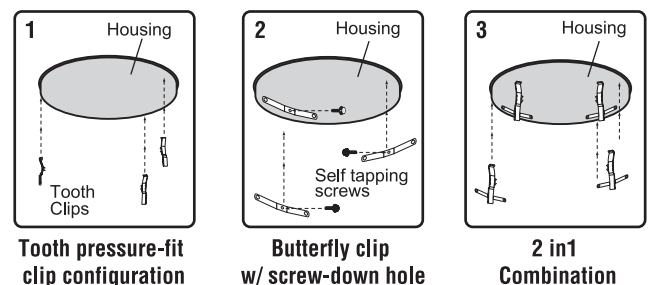

1 Tooth pressure-fit clip configuration

2 Butterfly clip w/ screw-down hole

3 2 in1 Combination